

HIGH PRESSURE FILTER HOUSING – WHFITFC

(flanged connection)

DESCRIPTION

WHFITFC welded high pressure stainless steel filter housings with threaded connections have been developed for filtration of compressed air as well as many other gasses ⁽¹⁾ where the risk for corrosion is very high or where stainless steel housing is required. To meet the required gas quality appropriate filter element must be installed into filter housing.

APPLICATIONS ⁽²⁾

- Packing industry
- Biotechnology
- Breweries
- Chemical industry
- Diaries
- Fermentation processes
- Food & beverage industry
- Pharmaceutical industry
- Hospitals

⁽¹⁾ For any other technical gas please contact us or your local dealer

⁽²⁾ WHFITFC process filter housing can be used in variety of applications. For applications not listed please contact us or your local dealer.

⁽³⁾ For oil removal, coalescing filter element must be installed and flow direction inside-out must be provided. General arrangement is filter head on top and filter bowl on bottom.



TECHNICAL SPECIFICATION

Operating temperature ⁽⁴⁾	0 - 120 °C	32 - 248 °F
Operating pressure	0 – 50 bar(g)	0-725 psi

⁽⁴⁾ Actual operating temperature depends on sealing material and type of filter element.

MATERIALS

Housing material	Stainless steel (quality 1.4404; on request 1.4301)
Sealing	FKM (Optional EPDM or SILICONE)
Lubricant	(Optional Shell Cassida Grease RLS 2)



FLOTECH
Compressor & Vacuum Parts Ltd

PRODUCT DATA SHEET

SIZES

FILTER HOUSING	PIPE SIZE [inch] - D	FILTER ELEMENT	FLOW CAPACITY		DIMENSIONS [mm]			VOLUME [l]	WEIGHT [kg]
			[Nm ³ /h]	[scfm]	A	B	C		
WHFITFC 010	1/2"	0420	150	88	244	121	76,1	0,84	2,6
WHFITFC 018	3/4"	0520	225	132	268	121	76,1	0,93	2,8
WHFITFC 030	1"	0525	315	185	302	143	88,9	1,3	3,4
WHFITFC 047	1 1/4"	0725	420	247	335	160	88,9	1,74	3,9
WHFITFC 070	1 1/2"	0730	600	353	402	182	114,3	3,4	5,6
WHFITFC 094	2"	1030	900	530	469	180	114,3	4,1	6,2
WHFITFC 150	2"	1530	1260	742	606	180	114,3	5,3	6,9
WHFITFC 200	3"	3030	2400	1413	1028	228	139,7	14	11,5

Flow capacity at 7 bar(g), 20°C

Standard is BSP pipe connection, other pipe connection on request.

PRESSURE EQUIPMENT DIRECTIVE PED 2014/68/EU (Fluid group 2)

WHFITFC 010 - WHFITFC 018	Article 4.3
WHFITFC 030 - WHFITFC 070	Category 1, Module H
WHFITFC 094 - WHFITFC 200	Category 2, Module H

PRESSURE EQUIPMENT DIRECTIVE PED 2014/68/EU (Fluid group 1) ⁽⁵⁾

WHFITFC 010 - WHFITFC 018	Article 4.3
WHFITFC 030 - WHFITFC 070	Category 2, Module H
WHFITFC 094 - WHFITFC 200	Category 3, Module H

⁽⁵⁾ Fluid group must be specified in the order, if not standard fluid group 2 is selected.

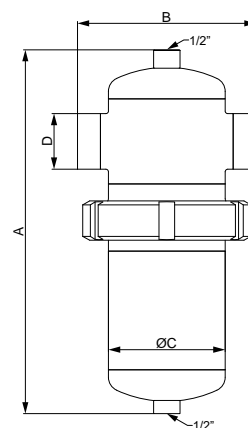

CORRECTION FACTORS

To calculate the correct capacity of a given filter based on actual operating conditions, multiply the nominal flow capacity by the appropriate correction factor(s).

CORRECTED CAPACITY = NOMINAL FLOW CAPACITY x C_{OP}

OPERATING PRESSURE

[bar]	3	5	7	10	13	16	20	30	40	50
[psi]	44	72	100	145	189	232	290	435	580	725
C _{OP}	0,50	0,75	1	1,38	1,75	2,13	2,63	3,88	5,13	6,38

MAINTENANCE

Replace filter element at least every 12 months or follow the instructions for specific filter element. Once per year make a visual check of filter housing and make sure there is no visual damage.

INFORMATION IN THIS DOCUMENT IS SUBJECT TO CHANGE WITHOUT NOTICE

	<p>Our quality management system is certified by BUREAU VERITAS in conformity with ISO 9001:2008 Reg. number: 200285</p>	
---	--	--



FLOTECH
Compressor & Vacuum Parts Ltd