

STAINLESS STEEL STERILE FILTER HOUSING – SPFFC

DESCRIPTION

SPFFC stainless steel sterile filter housings have been specifically developed for applications in process industry, where the risk for corrosion of compressed air ⁽¹⁾ system components is very high. To meet the required compressed air quality ⁽³⁾ appropriate filter element (Sterile filter cartridge) must be installed into filter housing.

APPLICATIONS ⁽²⁾

- Packing industry
- Biotechnology
- Breweries
- Chemical industry
- Diaries
- Fermentation processes
- Food & beverage industry
- Pharmaceutical industry
- Hospitals



⁽¹⁾ For a specific technical gas please contact us or your local dealer

⁽²⁾ SPFCF process filter housing can be used in variety of applications. For applications not listed please contact us or your local dealer.

⁽³⁾ For oil removal, coalescing filter element must be installed and flow direction inside-out must be provided. General arrangement is filter head on top and filter bowl on bottom.

TECHNICAL SPECIFICATION

Operating temperature ⁽⁴⁾	-20 - 150 °C	-4 - 302 °F
Short duration (15min) temp limit	Up to 200 °C	Up to 392 °F
Operating pressure	0 – 14 bar(g)	0 – 203 psi

⁽⁴⁾ Actual operating temperature depends on sealing material and type of filter element.

MATERIALS

Housing material	Stainless steel (quality 1.4404; on request 1.4301)
Sealing	EPDM (Optional FKM or SILICONE)
Housing finishes	Polished down to grade Ra0,8 (externally)
Lubricant	(Optional Shell Cassida Grease RLS 2)



SIZES

FILTER HOUSING	PIPE SIZE-D [inch]	FILTER ELEMENT	OPERATING PRESSURE	FLOW CAPACITY		DIMENSIONS [mm]				VOLUME [l]	WEIGHT [kg]
				[Nm ³ /h]	[scfm]	A	B	C	E		
SPFFC 005	1/4"	0310	14	75	44	225	120	76,1	1/8"	0,71	1,9
SPFFC 007	3/8"	0410	14	105	62	251	120	76,1	1/8"	0,8	2,0
SPFFC 010	1/2"	0420	14	150	88	258	121	76,1	1/8"	0,84	2,1
SPFFC 018	3/4"	0520	14	225	132	282	121	76,1	1/8"	0,93	2,3
SPFFC 030	1"	0525	14	315	185	299	136	88,9	1/8"	1,4	3,1
SPFFC 047	1 1/4"	0725	14	420	247	359	155	88,9	1/8"	1,74	3,4
SPFFC 070	1 1/2"	0730	14	600	353	395	180	114,3	1/4"	3,4	4,7
SPFFC 094	2"	1030	14	900	530	464	180	114,3	1/4"	4,1	5,3
SPFFC 150	2"	1530	14	1260	742	592	180	114,3	1/4"	5,3	6,0
SPFFC 175	2 1/2"	2030	14	1680	989	743	226	139,7	1/4"	10,2	11,4
SPFFC 200	3"	3030	14	2400	1.413	995	226	139,7	1/4"	14	12
SPFFC 240	3"	3050	14	3600	2.119	1029	256	168,3	1/4"	21	18

Flow capacity at 7 bar(g), 20°C

Standard is BSP pipe connection, other pipe connection on request.

PRESSURE EQUIPMENT DIRECTIVE PED 2014/68/EU (Fluid group 2)

SPFFC 005 - SPFFC 094	Article 4.3
SPFFC 150 - SPFFC 200	Category 1, Module H
SPFFC 240	Category 2, Module H

PRESSURE EQUIPMENT DIRECTIVE PED 2014/68/EU (Fluid group 1)⁽⁵⁾

SPFFC 005 - SPFFC 047	Article 4.3
SPFFC 070 - SPFFC 094	Category 1, Module H
SPFFC 150 - SPFFC 200	Category 2, Module H
SPFFC 240	Category 3, Module H

⁽⁵⁾ Fluid group must be specified in the order, if not standard fluid group 2 is selected.

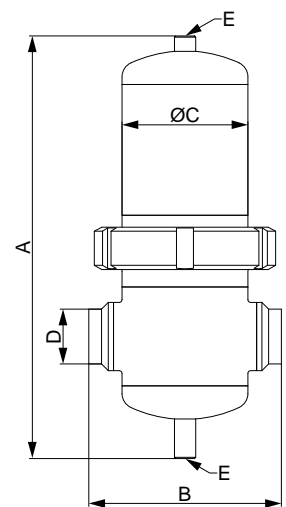

CORRECTION FACTORS

To calculate the correct capacity of a given filter based on actual operating conditions, multiply the nominal flow capacity by the appropriate correction factor(s).

CORRECTED CAPACITY = NOMINAL FLOW CAPACITY x C_{OP}

OPERATING PRESSURE

[bar]	2	3	4	5	6	7	8	9	10
[psi]	29	44	58	72	87	100	115	130	145
C _{OP}	0,38	0,5	0,63	0,75	0,88	1	1,13	1,25	1,38

MAINTENANCE

Replace filter element at least every 12 months or follow the instructions for specific filter element. Once per year make a visual check of filter housing and make sure there is no visual damage.

INFORMATION IN THIS DOCUMENT IS SUBJECT TO CHANGE WITHOUT NOTICE

	Our quality management system is certified by BUREAU VERITAS in conformity with ISO 9001:2015 Reg. number: 200285
---	--



FLOTECH
Compressor & Vacuum Parts Ltd