

STAINLESS STEEL AIR VENTING FILTER HOUSING - AVFC

(Process and sanitary applications)

DESCRIPTION

AVFC stainless steel filter housings have been developed to remove impurities from air⁽¹⁾ which is being feed or exhausted from tank during changing of liquid level. To meet the required air quality appropriate filter element (typically AVFFC filtration grade) must be installed into filter housing. AVFC filter housing is also designed for sterilisation. Before use, if needed for the application, sterilize the filters.



APPLICATIONS⁽²⁾

- Packing industry
- Biotechnology
- Breweries
- Chemical industry
- Dairies
- Fermentation processes
- Food & beverage industry
- Pharmaceutical industry
- Water treatment systems

⁽¹⁾For any other technical gas please contact us or your local dealer

⁽²⁾AVFC venting filter housing can be used in variety of applications. For applications not listed please contact us or your local dealer.

TECHNICAL SPECIFICATION

Operating temperature	Up to - 200 °C*	Up to - 302 °F
Operating pressure	Ambient pressure (max 1.0 bar(g) due to pressure drop on filter element)	

*Actual operating temperature depends on fully assembled unit with filter element. For temperatures below 0°C contact manufacturer.

MATERIALS

Housing material	Stainless steel (quality 1.4301; on request 1.4404)
Housing finishes	Polished down to grade Ra0,8

SIZES

FILTER HOUSING	CONNECTION [DIN 11851]*	FILTER ELEMENT	Flow capacity		DIMENSIONS [mm]			WEIGHT [kg]
			[Nm ³ /h]	[scfm]	A	ΦB	C	
AVFC 006	DN 32	1x0310 AVF	9	5	115	88,9	Rd 58 x 1/6	1,6
AVFC 027	DN 40	1x0525 AVF	25	14	176	114,3	Rd 65 x 1/6	2,4
AVFC 032	DN 50	1x0530 AVF	40	23	184	114,3	Rd 78 x 1/6	2,5
AVFC 072	DN 50	1x1030 AVF	110	64	320	114,3	Rd 78 x 1/6	3,4
AVFC 144	DN 80	1x2030 AVF	210	123	565	168,3	Rd 110 x 1/4	9,5
AVFC 192	DN 80	1x3030 AVF	310	182	820	168,3	Rd 110 x 1/4	12,0

*Tri-Clamp connection on request

PRESSURE EQUIPMENT DIRECTIVE PED 97/23/EC (Fluid group 2)

AVFC 006 - AVFC 192	Not required
---------------------	--------------

MAINTENANCE

Replace filter element at least every 12 months or follow the instructions for specific application. Once per year make a visual check on filter housing and make sure there is no visual damage.

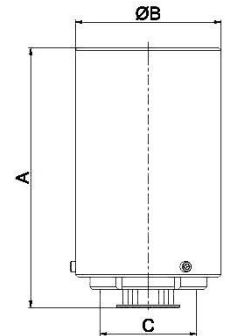

INFORMATION IN THIS DOCUMENT IS SUBJECT TO CHANGE WITHOUT NOTICE

	Our quality management system is certified by BUREAU VERITAS in conformity with ISO 9001:2008 Reg. number: 200285	
--	--	--