

MDHFC 200 / MDHFC 420

DIFFERENTIAL PRESSURE DROP INDICATOR

DESCRIPTION

Magnetic differential manometer MDHFC is designed to indicate pressure drop across the filter element in compressed air system ⁽¹⁾. It detects when the filter cartridge is clogged and should be replaced. MDHFC is usually installed on the head of the filter housing. Double dials on manometer allows readout values from both sides of the differential manometer. Thanks to resistance stainless steel housing is also suitable for demanding applications.



APPLICATIONS ⁽²⁾

- Automotive
- Electronics
- Food & Beverage
- Chemical
- Petrochemical
- Plastics
- Paint
- General industrial application

⁽¹⁾ For any other technical gas please contact us or your local dealer

⁽²⁾ MDHFC can be used in variety of applications. For applications not listed please contact us or your local dealer.

TECHNICAL SPECIFICATION

Ambient temperature	1,5 - 80 °C	35 - 175 °F
Measuring range	0 – 1 bar	0 – 14,7 psi
Static pressure	MDHFC 200	200 bar 2900 psi
	MDHFC 420	420 bar 5801 psi
Accuracy class	±5% of full scale (ascending)	
Calibration mode	In ascending direction only	
Migration of media	Minor from high to low port	
Dial	Ø63mm on both sides	
Connection	On body G1/4" female – reducing fittings G1/8" male	
Overpressure safety	Either side to maximum working pressure	
Environmental protection	IP 65	

MATERIALS

	MDHFC 200	MDHFC 420
Pressure chamber with connection	Anodized Aluminium	Stainless steel 1.4401
Fittings	Stainless steel 1.4571	
Piston	Ceramic magnet and Teflon seals	
Compression spring	Stainless steel 1.4319	
Seals	NBR	
Dial housing	Stainless steel 1.4301	
Dial pointer	Aluminium	
Window	Float glass	

DIMENSION

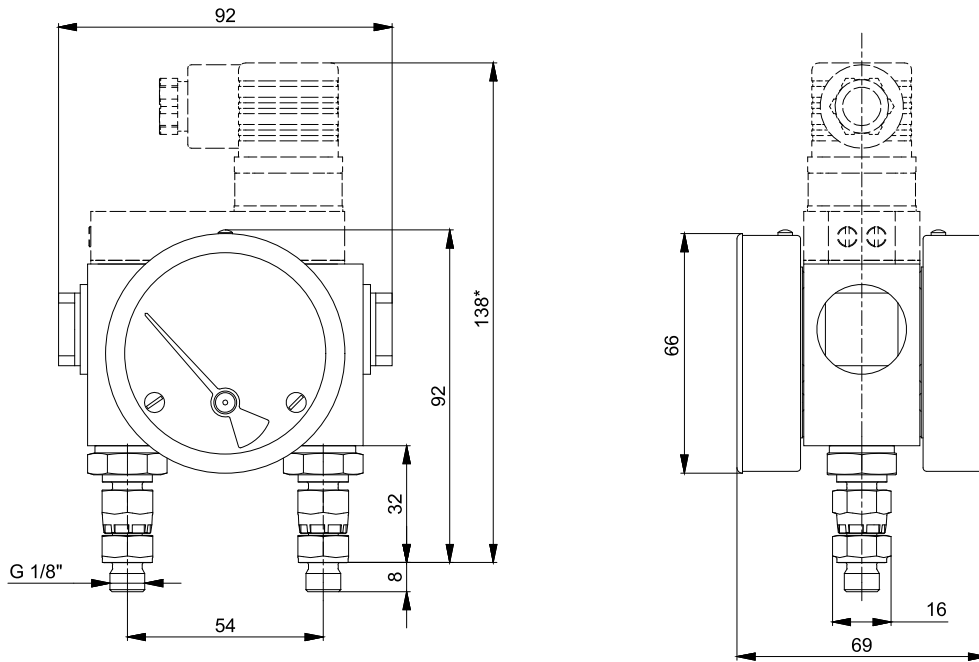

* This dimension is only valid for version MDH200C and MDH400C.

TYPES

Model	Description
MDHFC 200, MDHFC 420	basic version
MDHFC 200C, MDHFC 420C	voltage-free contact version for remote alarm

SWITCH SPECIFICATION

Contacts	NO contact
Type of contact	Reed
Switch set points	Ascending
Switching point 1 ⁽³⁾	Factory set ≈20% of range
Switching point 2 ⁽³⁾	Factory set ≈80% of range
Max. Switching voltage	230V AC/DC
Max. Switching current	1A AC/DC
Max. Switching power	40VA
Connection	DIN plug

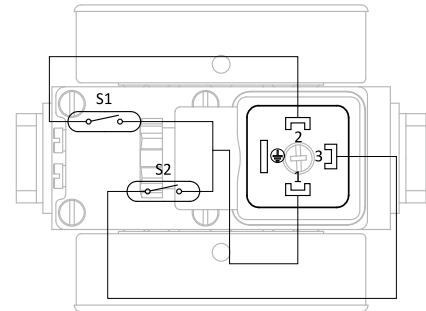

⁽³⁾ Switches are adjustable between 20 to 80% of range.

MAINTENANCE

Once per year make a visual check of the pressure drop indicator and make sure there is no visual damage or leakage.

INFORMATION IN THIS DOCUMENT IS SUBJECT TO CHANGE WITHOUT NOTICE

	<p>Our quality management system is certified by BUREAU VERITAS in conformity with ISO 9001:2015 Reg. number: 200285</p>	
--	--	--